

## £310,000

### Nicholas Crescent, Fareham, PO15 5AJ

**DRAFT DETAILS :** We are awaiting verification from the Vendor that these details are correct



- Semi-Detached Bungalow
- Two Bedrooms
- Lounge
- Kitchen
- Conservatory
- Bathroom
- Rear Garden
- Garage & Driveway
- NO ONWARD CHAIN!
- Energy Efficiency Rating: E/46

Score	Energy rating	Current	Potential
92+	A		
81-91	B		89 B
69-80	C		
55-68	D		
39-54	E	46 E	
21-38	F		
1-20	G		

Property Reference : F2162

Council Tax Band: B

Floor Plans ( For illustrative purposes and not drawn exactly to scale)

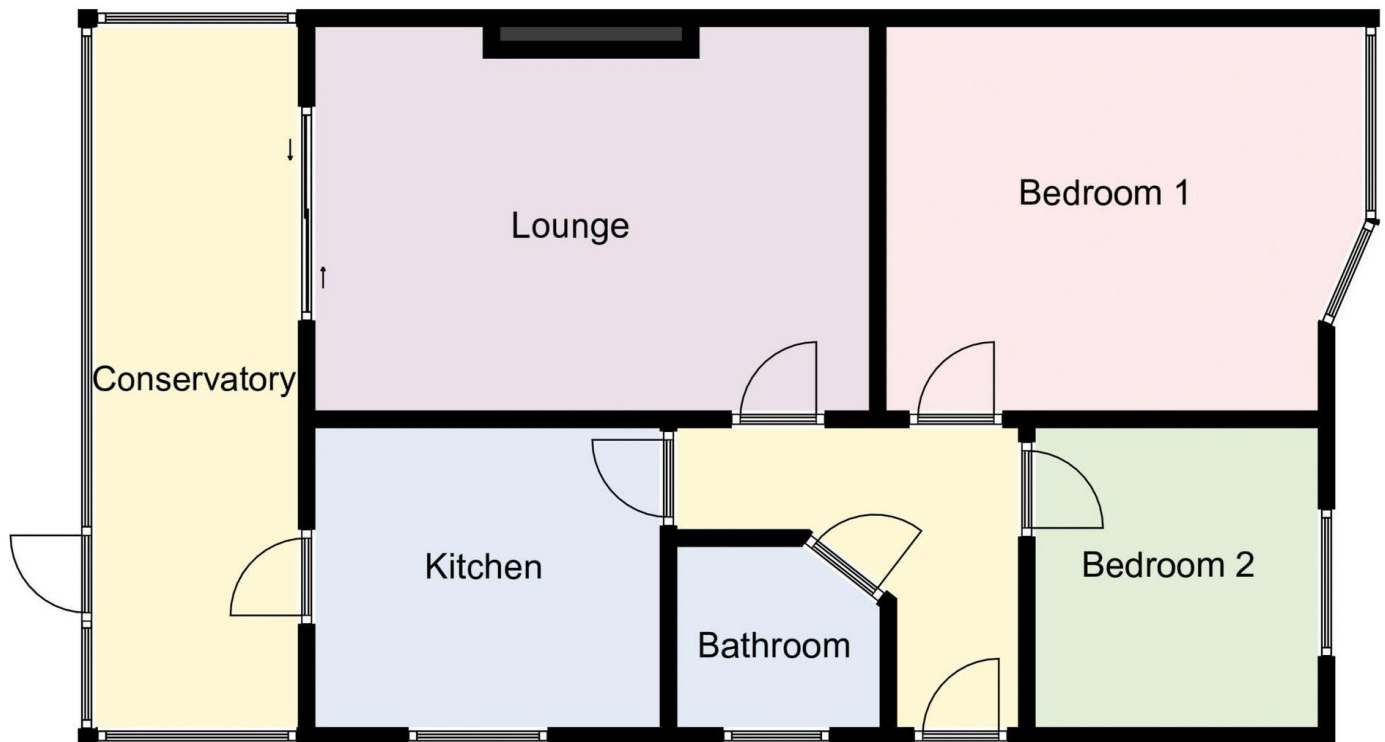

## The Accommodation Comprises:-

Front door into:-

### Entrance Hall:-

### Lounge:-

15' 5" x 10' 6" (4.70m x 3.20m)

Sliding patio doors onto conservatory, coal-effect wall-mounted gas fire, radiator.



### Kitchen:-

9' 7" x 8' 1" (2.92m x 2.46m)

Window to side and door giving access to conservatory, range of refitted base and eye level units with single drainer sink unit with mixer tap, induction ceramic hob with concealed extractor, oven and grill, wall-mounted Worcester gas central heating boiler concealed in unit, integrated dishwasher.



### Conservatory:-

19' 4" x 5' 7" (5.89m x 1.70m)

Door giving access and enjoying views of the garden, plumbing and space for washing machine.



**Bedroom 1:-**

13' 7" x 10' 6" (4.14m x 3.20m)

Window to front elevation, radiator.

**Bedroom 2:-**

8' 2" x 7' 10" (2.49m x 2.39m)

Window to front, radiator.

**Bathroom:-**

5' 7" x 4' 11" (1.70m x 1.50m)

window to side, close-coupled wc, wash hand basin with mixer tap inset vanity unit, tiled panelled bath with Triton shower over, shower screen, tiled, long-line chrome towel rail.



## Outside:-

Bordered by dwarf brick wall, shared driveway to the rear, hardstanding and lawns.



**Disclaimer:** These particulars are set out as a general outline in accordance with the Consumer Protection from Unfair Trading Regulations 2008 (CPR's) and Business Protection from Misleading Marketing Regulations 2008 (BPR's) only for the guidance of intending purchasers or lessees, and do not constitute any part of an offer or contract. Details are given without any responsibility, and any intending purchasers, lessees or third parties should not rely on them as statements or representations of fact, but must satisfy themselves by inspection or otherwise as to the correctness of each of them.

We have not carried out a structural survey and the services, appliances and specific fittings have not been tested. All photographs, measurements, floor plans and distances referred to are given as a guide only and should not be relied upon for the purchase of carpets or any other fixtures or fittings. Gardens, roof terraces, balconies and communal gardens as well as tenure and lease details cannot have their accuracy guaranteed for intending purchasers. Lease details, service ground rent (where applicable) are given as a guide only and should be checked and confirmed by your solicitor prior to exchange of contracts.

No person in the employment of Fenwicks Estates Ltd has any authority to make any representation or warranty whatever in relation to this property. Purchase prices, rents or other prices quoted are correct at the date of publication and, unless otherwise stated, exclusive of VAT.

**Data Protection:** We retain the copyright in all advertising material used to market this Property.

**Money Laundering Regulations 2017:** Intending purchasers will be required to produce identification documentation once an offer is accepted